



USER MANUAL

DIRECT COOL REFRIGERATOR

**RD SRF 225, RD EP 230 BD, RD SRF 250,
RD VARS 26 DGS, RD SRF 275**

Godrej & Boyce Mfg. Co. Ltd. - Appliance Division

MADE IN INDIA

CONTENT

1. PARTS IDENTIFICATION	1
2. SPECIAL FEATURES	3
3. INSTALLATION	5
4. OPERATION	6
5. USEFUL SUGGESTIONS FOR STORAGE AND OPERATION	7
6. BEFORE CALLING FOR SERVICE	8
7. FREQUENTLY ASKED QUESTIONS	9
8. SAFETY PRECAUTIONS	10
9. WARRANTY	11

1. PARTS IDENTIFICATION

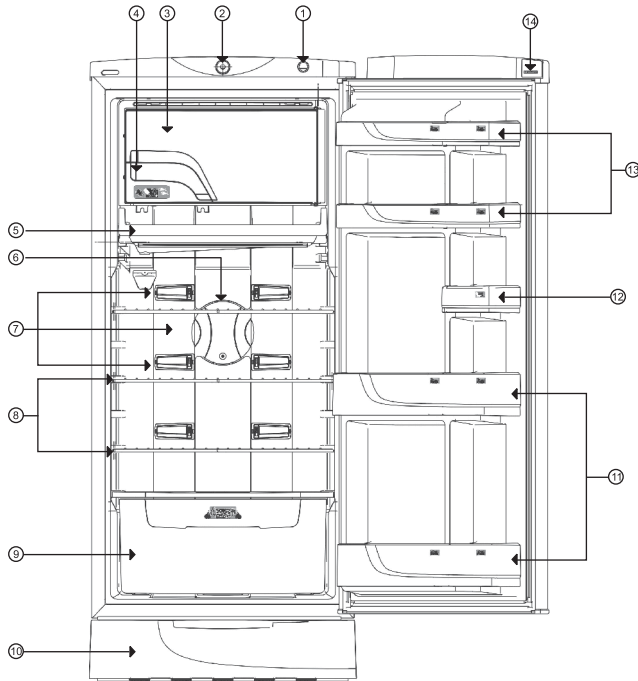

1. Light Switch

5. Chiller Tray

9. Vegetable Tray

13. Utility Shelves

2. Thermostat & Defrost Button

6. Lamp

10. Dry Store

14. Lock

3. Freeze Express*

7. Convection Control Technology*

11. Bottle Shelves

4. Chill Express*

8. Adjustable Shelves

12. Step Utility Shelves

*Image shown is representative only. Some parts are specific to certain models. Hence, there could be some parts which are not in your refrigerator.

1. PARTS IDENTIFICATION

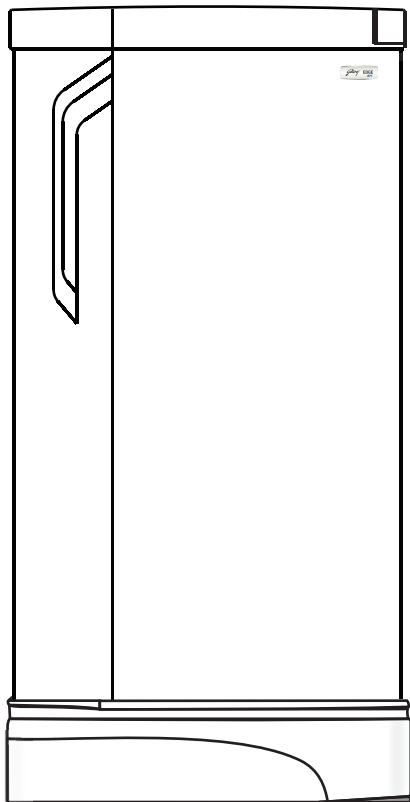

*Image shown is representative only. Some parts are specific to certain models. Hence, there could be some parts which are not in your refrigerator.

2. SPECIAL FEATURES

- **Convection Control Technology***: Special ducts run across the length of the Godrej Edge refrigerator. Fitted with flaps, these help to control air circulation. If the refrigerator shelves are stacked completely, the unique Convection Control Technology comes to your aide. You can use the knobs to keep the flaps in their open state to ensure free circulation of air. This helps to ensure proper cooling despite heavy load in the refrigerator.



Convection
Control Technology

- **Freeze Express***: Godrej Edge is equipped with a uniquely designed step freezer - aptly called Freeze Express. Its step design helps to hasten the freezing especially when there is a larger volume to freeze. This design also ensures maximum utilization of space along with the added advantage of being able to segregate vegetarian and non-vegetarian food items.

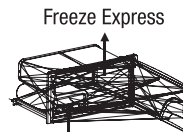

Chill Express

- **StayCool Technology***: Unique StayCool gel pack in the freezer provides superior cooling retention, keeping ice intact for a long time, even during power cuts. This ensures longer lasting cooling in the main compartment as well, along with reduced wastage and reduced cleaning hassles during power cuts.

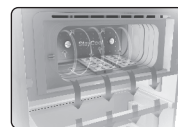

StayCool
Technology

- **Chill Express***: As an added utility stemming from the special freezer, Godrej Edge offers a special chilling zone - Chill Express. This space can be used to chill water or soft drinks etc. when in a hurry.

2. SPECIAL FEATURES

- **Dry Store***: Godrej Edge packs an extra multi utility tray at the bottom where you can store your dry vegetables like potato, onion, garlic etc.



- **Adjustment of Stability leg in Edge PDS** : When refrigerator is used without base insure both the legs of refrigerators are in place and properly leveled.
- **Toughened glass Description** : Glass Shelves are made of Toughened Glass which is capable of withstanding a load of 150kg# so that you can place Heavy Utensils with ease and straight from your kitchen.

*Features available in select models.

3. INSTALLATION

1. Select the right location

- Avoid extreme heat and cold by placing your refrigerator away from direct sunlight and heat sources such as ovens, cooking ranges etc. and also from direct air drafts like windows, fans etc. Also, do not install it close to a gas cylinder.
- Place your refrigerator close to an electrical outlet. Do not use an extension cord.

2. While Installing

- Provide at least 6 inches (15 cm) space at the back, both sides and the top to ensure adequate air circulation.
- Install the refrigerator properly on a flat and firm surface so it stands erect. If the floor is not level, you can use packing to keep your refrigerator balanced and stable. Levelling screws have also been provided in select models.

3. Connect

- Your refrigerator operates on AC 220-240 V~, 50 Hz power supply. A voltage stabiliser is advisable if there is wide fluctuation in supply voltage. Connect the plug to a 3 pin, 5 amps socket. Ensure that the wall socket is properly earthed by having it checked by a qualified electrician. It is safe to use a socket with a fuse and a switch.
- Wires should be kept off the floor, for if water drips onto the floor, it may cause a short circuit.
- Switch on the power supply, set the temperature control at the maximum setting and let the machine run for about 4 hours. Thereafter turn the knob to 'normal' or 'minimum' setting according to your requirement and your refrigerator is ready to use.

4. Recycle

- After installing the refrigerator, recycle/reuse the corrugated box fitments and polythene cover/straps. Do not dispose them off as garbage. This helps to conserve resources and prevent pollution.

4. OPERATION

1. Temperature Setting

- Set the temperature control knob towards Maximum/Coldest during peak summers/when you want quick ice/when you have stored large quantities of food inside. Set the knob towards Minimum during winters/when you have stored very small quantities of food. Several factors affect the temperature in the refrigerator its position, room temperature, number of door openings, relative humidity, temperature at which food is stored etc. So adjust the temperature control knob occasionally to allow for these factors. Do not set the temperature lower than required. It will increase energy consumption unnecessarily.

2. Defrosting

- Moisture in the air condenses on a cold surface - this leads to frost formation in the freezer. Excess frost formation in the freezer acts as an insulator and restricts cooling effect, reducing efficiency. Defrosting reduces running time and therefore power consumption.
- Remove all food items from the freezer and chiller before you defrost.
- To defrost, just push the button on the temperature control knob. Frost in the freezer will begin to melt and can be easily removed. The water will evaporate from the defrost water tray at the back of your refrigerator. After defrosting is finished, the refrigerator will start automatically.
- Defrosting should be carried out every 3 days. Hot, humid climate will result in quicker frost formation necessitating more frequent defrosting. Frost should not exceed 6 mm (1/4"). Delay in defrosting may lead to defrost water spilling on to the floor and within the refrigerator. Do not use a sharp object like knife to remove ice from the freezer. Avoid opening the door during defrosting.

3. Cleaning

- It is advisable to clean your refrigerator once a month.
- Before cleaning, switch the refrigerator off and remove the power plug. Remove all food items.
- Use mild soap solution and wipe the refrigerator gently. Dry it with a clean cloth. Clean both the exteriors and interiors. Leave the door open for a while to let the refrigerator dry.
- Do not let the water get into the light bulb box and other electrical components. Never use solvents, acids, baking soda solution or abrasive powders to clean the refrigerator as these may damage the surface.
- Cockroaches and insects can only creep into your refrigerator through the door. So always shut the door firmly. Ensure that the gasket is in good shape and keep the surroundings free from insects and rodents.
- It is important to keep the exteriors of the refrigerator dry to avoid rusting, especially the lower front edge of the cabinet as well as the bottom surfaces of the door.

5. USEFUL SUGGESTIONS FOR STORAGE AND OPERATION

- Store fresh food in the refrigerator, as food can only be preserved but not rejuvenated.
- Do not store hot food items in the refrigerator. Allow them to cool to room temperature before storing.
- All moist foods should either be packed in containers or wrapped in polythene bags or aluminium foil.
- It is better to freeze meats in bigger pieces. So mincing the meat in advance should be avoided.
- Ice Cream should be kept on the floor of the freezer. It may still stay soft as ice creams remain hard only in deep freezers at very low temperatures.
- Do not store liquids in cans or bottles in the freezer as they may burst.
- Milk should be refrigerated after being boiled and cooled to an ambient temperature. Milk packets should be kept in the chiller zone.
- Vegetables can be kept fresh for a longer time if their moisture content is retained. Loosely wrap all vegetables, especially the leafy ones, in polythene bags. The roots of green leafy vegetables can be cut before storing.
- Fruits and vegetables with a strong odour should be wrapped tightly in polythene bags. Ripe fruits should not be stored with vegetables as they release ethylene gas that turns certain vegetables like lettuce brown.
- If fruits and vegetables are washed before storing, they should be thoroughly drained of water. Excess moisture can lead to decay.
- Don't cover the shelves with paper or plastic sheets. This restricts air circulation inside the refrigerator.
- Don't open the door too often or for longer periods than is necessary. This raises the internal temperature. During a power failure, minimise the number of door openings.
- If you are going away for an extended period (say more than a week), remove all food items, switch off the refrigerator and disconnect the power plug. Defrost and clean thoroughly as recommended. Leave the door slightly open to prevent odour.

6. BEFORE CALLING FOR SERVICE

Type of Complaint	Probable Cause	Remedy
1. Refrigerant does not work	- Thermostat switch in OFF position. - Power Supply is Off	Check that the thermostat knob is in on position and not in off position. Check that the refrigerator main supply plug is connected to the wall socket and fuse is intact in the supply line
2. Refrigerator attempts to start, but does not operate.	- Low Voltage.	Install a line-correcting transformer in the mains, or a Voltage Stabilizer
3. Refrigerator contents not cooling.	- Defrosting over due - Restriction of cold air circulation. - Improper thermostat Control Selection. - Entry of hot air.	Defrost the refrigerator Provide space in between the dishes. If the shelves are covered with cloth or polythene, remove it If the refrigerator is required to give a low temperature turn the thermostat knob clockwise to the right more position Opening and closing of the door too often will result in hot air from outside rushing into the refrigerator causing the temperature to go up. Reduce the frequency of opening of the door
4. Formation of water drops on exterior of refrigerator	- High humidity during monsoon season.	During monsoon, when the humidity in the atmosphere reaches around 90% water droplets may form around the sides of the refrigerator cabinet, especially the top portion. This moisture should be wiped off periodically. Contact our serviceman to check the door seal for proper and uniform contact with the cabinet
5. Formation of droplets on the underside of Chiller tray.	- Hot and humid climate.	In hot and humid weather the moist air rushes inside whenever the refrigerator door is opened. This results in excess frosting on the Evaporator, and the condensation on the Chiller tray bottom. Avoid frequent door openings.
6. Smell and odour.	- Improper covering and wrapping of food.	Wrap and cover foodstuffs properly. Place caps on bottles and other liquid stores. If the smell persists, defrost and remove all foodstuffs, clean the refrigerator thoroughly and wipe it dry before restarting.
7. Difficulty in formation of ice and ice-cream	- Incorrect thermostat setting - Defrosting overdue	Move the thermostat clockwise to extreme right position. Excessive frost on the freezer, should be defrosted. Ensure that the container of ice-cream or ice is in proper contact with the surface of the freezer. Do not use bowls.

7. FREQUENTLY ASKED QUESTIONS

Q. How often should I defrost my refrigerator?

Ans. It is good to defrost the refrigerator every 3rd day to avoid water spillage and ensure optimal cooling performance. You may need to do it more often depending on your temperature settings. It is a must to do it at-least once a week.

Q. Is it ok to run my refrigerator on inverter or generator?

Ans. You can use a generator if needed, depending on its capacity but inverters are not advisable.

Q. How often should I clean my refrigerator?

Ans. You should clean the refrigerator once a month, as per instructions given in this guide.

Q. Why is there moisture in the vegetable tray?

Ans. As water in the vegetables evaporates, the vapours condense against the cold refrigerator tray surfaces resulting in water droplets.

8. SAFETY PRECAUTIONS

WARNING:

- When using this refrigerator, always exercise basic safety precautions, including the following: Locate, install and use the refrigerator properly in accordance with the instructions given in this user guide.
- Never unplug your refrigerator by pulling the power cord. Always grip the plug firmly and pull straight out from the wall socket after switching off the supply.
- Repair or replace immediately all electric service cords that have become frayed or otherwise damaged. Do not use a cord that shows cracks or damage by abrasion, rodents, etc.
- Do not keep anything on top of the refrigerator - such as lit candles, temples, cloth covers, electrical appliances like TV, lamp, etc.
- Do not splash water on or in the vicinity of the refrigerator. It could cause an electrical leak or malfunction.
- This appliance is not intended for use by person (including children) with reduced physical, sensory or mental capabilities, or lack of experience and knowledge, unless they have been given supervision or instruction concerning use of the appliance by a person responsible for their safety.
- Children should be supervised to ensure that they do not play with appliance.
- After your refrigerator is in operation, do not touch the cold surfaces in the freezer compartment, particularly when hands are damp or wet. Skin may adhere to these extremely cold surfaces and get hurt.
- Don't refreeze frozen foods which have thawed - completely or partially. Eating such refrozen foods could harm your health.
- Do not use supply cord that shows cracks or damage by abrasion, rodents, etc. If supply cord is damaged, it must be replaced by the manufacturer, its service agent or similarly qualified person in order to avoid a hazard.
- Do not store flammable sprays, vapour or liquids like gasoline, laquer and paint, volatile chemicals like benzene or ether, evaporating liquids like perfumes, nailpolish removers, etc inside the refrigerator. It may damage the food and some of these could also cause an explosion. Avoid storing these near the refrigerator as well.
- Do not use lubricants (lubricating oils, sprays, kerosene, WD-40, etc) on the hinges of the refrigerator doors. Some lubricants chemically react with plastics resulting in damage to doors.
- Refrigerator contains refrigerant and insulation contains gases, which must be disposed off professionally, to avoid any safety hazards.

WARNING: Do not use mechanical advices or other means to accelerate the defrosting process, other than those recommended by manufacture.

WARNING: Do not damage the refrigerant circuit.

WARNING: Do not use electrical appliances inside the food storage compartments of the appliances, unless they are of the type recommended by the manufacture.

WARNING: Keep ventilation openings, in the appliances enclosure or in the built-in-structure, clear of obstruction

- For replacing illuminating lamp use following instruction: -
 - Not all appliance bulbs will fit your refrigerator, but ensure to replace bulb with one of the same size, shape and wattage.
 - Unplug the cord from the outlet.
 - Remove the lamp cover by removing the screw.
 - Make sure the bulbs are cool to touch.
 - Remove the lamp by turning it clockwise.
 - Put new lamp & tighten it by turning counter clockwise.
 - Make sure bulb is properly tightened.
 - Put the cover lamp back and fit it with the screw.
- This appliance is intended to be used in household and similar application such as
 - Staff kitchen areas in shops, offices and other working environments;
 - Farm house and by clients in hotels, motels and other residential type environments;
 - Bed and breakfast type environments;
 - Catering and similar non-retail applications



This appliance contains a small amount of isobutane refrigerant (R600a), natural gas with high environmental compatibility, but is also combustible. When transporting and installing the appliance, care should be taken to ensure that no parts of the refrigerating circuit are damaged. Refrigerant squirting out of the pipes could ignite or cause an eye injury. If a leak is detected, avoid any naked flames or potential sources of ignition and ventilate the room in which the appliance is installed for several minutes.



Protection of Environment:

"Protection of environment" is one of the core values of Godrej and we seek your co-operation to make sure that this product is not disposed as unsorted municipal waste, as it contains hazardous substances like Lead, Mercury, Cadmium, Chromium, Polybrominated Biphenyls & Diphenyl ethers which can pollute environment and may lead to health hazards for human beings. This symbol is known as the "Crossed-out Wheelie Bin Symbol". It means that the product should not be disposed of with your general house-hold waste.

It should be disposed of only through the company's collection centers with special treatment so as to prevent any damage to the environment. Visit www.godrejappliances.com/green-think for details about Godrej Appliances authorized collection centers.

The user manual is also available online on our website. Please visit <http://www.godrejappliances.com/GodrejAppliances/downloadcenter.aspx?id=6&menuid=1421> for further information

9. WARRANTY

The Godrej refrigerator comes with a FIVE/TEN* years warranty on COMPRESSOR and a ONE year warranty on all other parts (Except bulb, glass and add-on plastic parts) from the date of purchase, against defective material or workmanship. In case of any such defect found during the first year from date of purchase, Godrej & Boyce Mfg. Co. Ltd. - Appliance Division will undertake repairs to the warranted part free of charge, subject to the terms and conditions below. In the warranty period beyond the first year from date of purchase, only the compressor will be provided free of cost. However, the appliance will be repaired on payment of necessary charges.

INSTRUCTIONS FOR THE CUSTOMER

1. Kindly ensure that the dealer fills the warranty card correctly and completely.
2. You should retain the warranty card for record and produce the same in the event of any warranty repairs.
3. In the event of a defect developing in the product, contact the nearest authorised Godrej & Boyce Service Centre for obtaining warranty service and provide the defect, model details & serial no.
4. Earthing of the appliance is necessary to ensure safety.
5. Product will function between +/-5% of the rated voltage. For any fluctuation beyond the specified limit, company shall not be responsible and the warranty stands terminated.
6. Frequency must be between 5% variation of 50 Hz. Beyond this, the company shall not be liable for any unforeseen hazards like fire, shock etc. and in turn, the warranty stands terminated.
7. In case, the appliance or any part thereof is subjected to neglect, abuse or misuse, tampering, alteration, accident, fire, floods or other acts of God, or damage by rodents or insects, the company is not responsible for any damage caused to the appliance and shall not be liable for any consequential loss or compensation nor refund of purchase price or replacement of the appliance.
8. If you are moving house, it is essential that a Godrej service representative inspects the refrigerator at the time of re-installation at the new address. The warranty on the product/optional service contract for the sealed system of the refrigerator continues to be effective only if the product is found to be in working condition. The reinspection will be done on the payment of necessary charges. We would also recommend that the product be insured against damage in transit.
9. Please follow the guidelines given regarding refrigerator, digital panel and music player usage.

Godrej & Boyce Mfg. Co. Ltd.- Appliance Division

CUSTOMER COPY

MODEL NO.

UNIT SR. NO.

DATE OF PURCHASE

CUSTOMER'S NAME & ADDRESS

DEALER'S NAME & ADDRESS

TEL. _____

Customer's Signature:

This warranty is valid only if it is filled in and stamped by our authorised dealer on the date of purchase.

Warranty for the Display Board/Control Panel stands null and void in the following cases

1. Water or other such liquids, foreign particles etc. seep into the Display Board/Control Panel components resulting in malfunctioning of the system or any other component of the refrigerator.
2. Foreign particles accumulate in the Display Board/Control Panel & it gets rusty.
3. Cap sensor damage due to excessive pressure exerted during operation, resulting in switch/product malfunction.

Warranty for the music player stands null and void in the following cases:

1. Water or other such liquids, foreign particles, etc. seep into the music player components resulting in malfunctioning of the sound system or any other component of the music player.
2. Foreign particles accumulate in the USB port or USB port gets rusty.
3. Keypad sticker tears off due to excessive pressure exerted during operation, resulting in switch/product malfunction.

Overall warranty also stands null and void if

1. The warranty card is not completed properly at the time of the purchase.
2. The completed warranty card is not presented to the authorised personnel at the time of service of the product.
3. The refrigerator is not operated according to instructions given in the User's Guide.
4. Defects are caused by improper use, which shall be determined by the company personnel.
5. Damage is caused to the refrigerator or any parts due to transportation or shifting.

TERMS AND CONDITIONS

1. *Ten year warranty on compressor applicable only on following Direct Cool Models-RD Edge Digi 192/212/241, RD Edge Pro 190 CT / PD / PDS, RD Edge Pro INV 190 / 210/ PDS, RD Edge ZX 195 CTS, RD Edge ZXL 195 PDS, RD Edge Diva 192 PDS, RD Edge Diva INV 192 / 212 PDS & RD Edge Digi 192 PD, RD Edge SX 221 CT INV 4.2 and all other Direct Cool Models greater than 190 L.
2. Repairs and replacements of parts will be carried out through the authorised Customer Service Centre.
3. All transportation and handling expenses incurred while repairing will be payable by the customer.
4. For any appliance installed beyond the municipal limits of the jurisdiction of the authorised customer service centre, charges towards technician's visit will be borne by the customer.
5. While the company will make every effort to carry out the repairs at the earliest, it however is made expressly clear that the company is under no obligation to do so in a specified period of time.
6. The company/its authorised personnel will collect any parts, compressor or other components replaced during warranty period only.
7. Warranty does not cover accessories to the appliance.
8. Sealed system gas charging and consumables will be charged for any such repairs after one year from the date of purchase.
9. The company's obligation under this warranty shall be limited to repair or providing replacement of parts only. The maximum claim/s if entertained by the company will be subject to the maximum retail price of the product purchased or purchase price, whichever is lower.
10. In the event of any unforeseen circumstances, and spares not being available, the company's prevailing depreciation rules will be binding on the purchaser to accept as a commercial solution in lieu of repairs.
11. Warranty is not applicable in case the original number (Serial No. Sticker) is removed, obliterated or altered from the machine or cabinet.
12. Warranty automatically expires after the stipulated period from the original date of purchase, even if the refrigerator was not in use for anytime for whatever reasons.

NOTES

[illegible]